

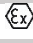

The Vision Remote VX-100 VLAP is a Zone 2 rated device used for supplying wireless link to the VX-100 RU when operating in hazardous area. Up to 3 VX-100 VLAP units can be connected to a single VX-100 BU giving good wireless range for the VX-100 RU units

Technical specifications

Operating temperature	-25 - +55 °C
Storage Temperature	-30 - +70 °C
EX rating	ATEX + IECEx  II 3G Ex ec ic mc IIC T4 Gc
Approvals	CE, ATEX and IECEx – EN60079-0, 7, 11 & 18
Ingress Protection (IP)	IP66
Physical Dimensions	300x230x168mm* (WxHxD)
Weight	Approx. 3 kg
Power supply	PoE
Radio Link	Vision Link - Proprietary redundant radio link consisting of: Highly reliable 434MHz or 869MHz and WiFi supporting 802.11n (2.4GHz/5.8GHz)
Indicators	1 Bi-colored status led
Cable gland	Input: Hawke 321-series M20 for cable Ø6,5-11,9mm
Cable termination	1x RJ45 + Screw terminals
Antenna Connector	TNC + 2x RP-SMA
Part number	VR-EXPR000202 (WiFi + 434MHz) VR-EXPR000203 (WiFi + 869MHz)
Pollution Degree	This equipment shall only be used in areas with pollution degree 2 or higher, as defined in IEC 60664-1

*Excl. external antennas

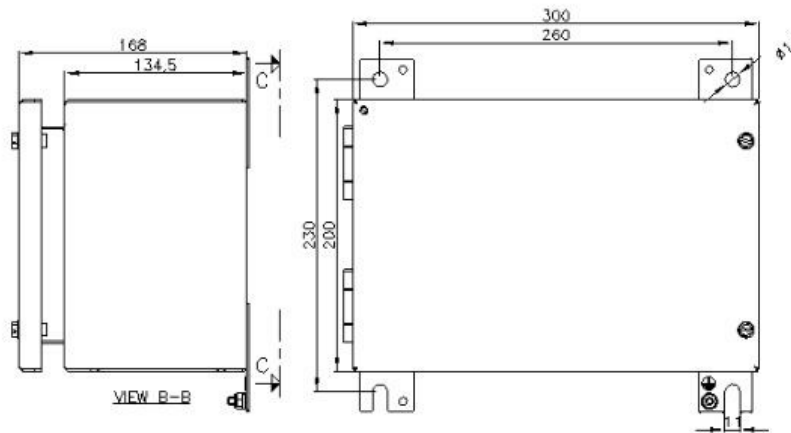

Installation notes:

Special precautions shall be taken to prevent corrosion on connection facilities

Please note that connection facilities shall be designed so that the electrical conductors cannot be readily loosened or twisted. This can be achieved by using appropriate strain reliefs. Cable gland must be tightened to the correct torque according to installation guide for the installed cable gland

Please visit https://hubbellcdn.com/installationmanuals/HKE_AI_451_321_CABLE%20GLANDS.pdf and find the latest installation guide for the 321-series cable gland

Input connections

RJ-45*

Pin	Signal	Colour
1	RX, DC+	White/Orange
2	RX, DC+	Orange
3	TX, DC-	White/Green
4	Spare	Blue
5	Spare	White/Blue
6	TX, DC-	Green
7	RS-485+	White/Brown
8	RS-485-	Brown

*Use Screened Ethernet cable

Terminal strip

Pin	Signal	Colour
1	RX, DC+	White/Orange
2	RX, DC+	Orange
3	TX, DC-	White/Green
4	Spare	Blue
5	Spare	White/Blue
6	TX, DC-	Green
7	RS-485+	White/Brown
8	RS-485-	Brown
9	GND	Screen
10	GND	Screen

Content of this datasheet is subject to change without notice.